

SALIENT DIMENSIONS*		
	TOP OF FLIP TAB mm [IN.]	BOTTOM OF WELL mm [IN.]
CHECKIT GO 2 μL**	16.40 [.646]	9.14 [.360]
CHECKIT GO 5 μL	16.40 [.646]	7.72 [.304]
CHECKIT GO 10 μL	16.40 [.646]	7.72 [.304]
CHECKIT GO 20 μL	16.40 [.646]	7.34 [.289]
CHECKIT GO 50 μL	16.53 [.651]	6.57 [.259]

* DIMENSIONS IN THIS TABLE MAY BE UP TO 0.5mm GREATER DUE TO FIT OF ASSEMBLED PARTS.

** WE SUGGEST CONTACT DISPENSING FOR SMALLER VOLUMES SUCH AS 2 μ L AND LESS.

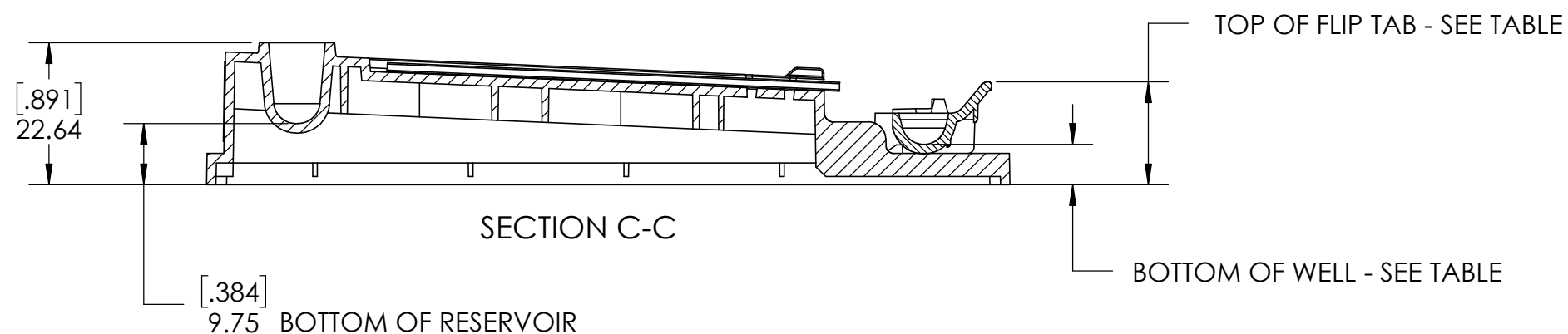

NOTES:
1. THE CHECKIT GO CARTRIDGE CONFORMS TO THE ANSI SLAS 4-2004 STANDARD FOR MICROPLATE WELL POSITIONS

THE INFORMATION CONTAINED IN THIS DRAWING IS THE SOLE PROPERTY OF NEXT ADVANCE, INC. ANY REPRODUCTION IN PART OR WHOLE WITHOUT THE WRITTEN PERMISSION OF NEXT ADVANCE, INC. IS PROHIBITED.

DIMENSIONS ARE IN mm [inches]
INTERPRET GEOMETRIC TOLERANCING PER ASME Y14.5M

THIRD ANGLE PROJECTION

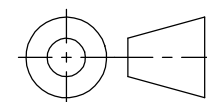

DO NOT SCALE DRAWING



2113 NY-7
Troy, N.Y. 12180 USA
Phone 1 518 674 3510

CHECKIT GO INTERFACE DWG

SIZE	DWG NO.	REV
B	7053534	07
SCALE 1:1	SHEET 1 OF 1	